

# SOCOREX<sup>®</sup> 自动连续注射器 快速指南

## 剂量设定

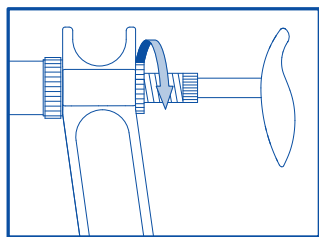

松开防松螺母

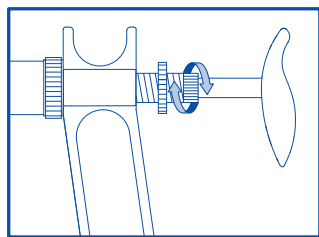

调整活塞至理想剂量

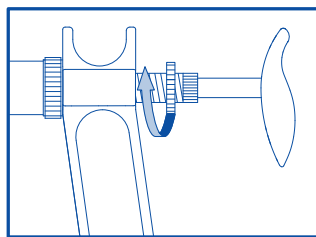

拧紧防松螺母

## 部件组装

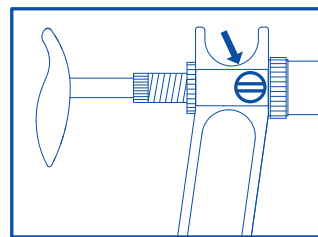

锁紧手柄侧螺丝，调整注射器主体和握把位置

## 附件安装：输液管

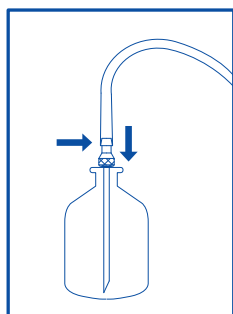

将输液管接入抽吸管，插入瓶中

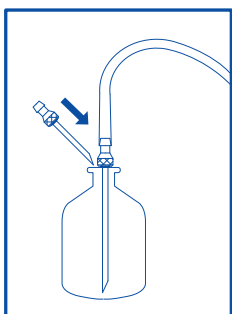

将排气管穿入橡胶塞

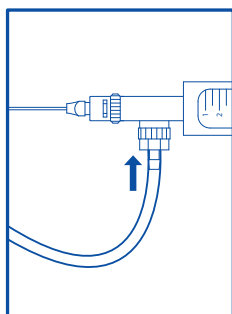

将输液管接入注射器

## 瓶架

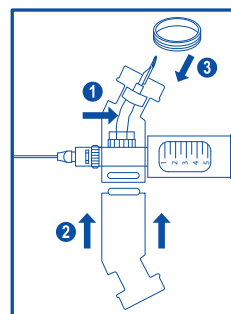

插入连接管和针头，组装零件

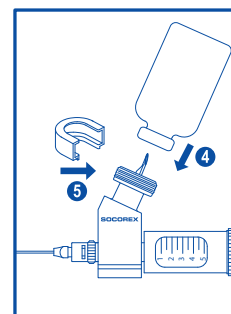

穿透橡胶塞，锁紧瓶子

## 填充液体

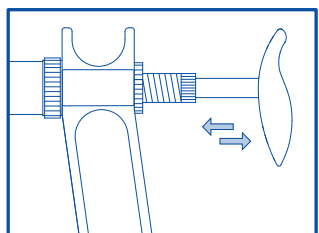

开始抽液直到液体到达针头

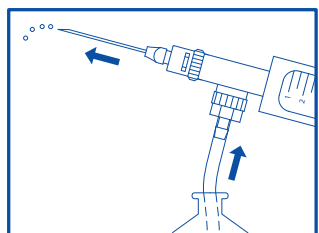

垂直位置排出多余液体以及气泡

## 阀门堵塞处理方法

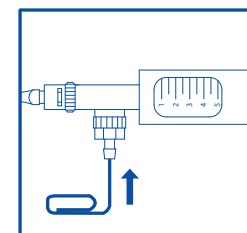

插入栓子，并推动以松开阀门球

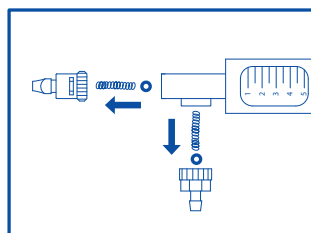

如未解决问题，拆卸阀门并清洗干净

## 日常维护：冲洗、拆卸和清洁

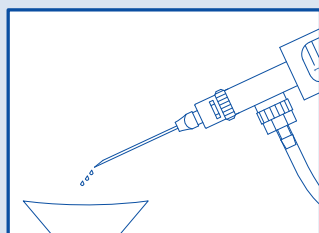

用温水彻底冲洗

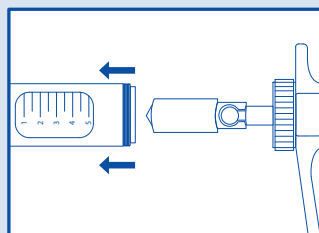

拆开注射器主体

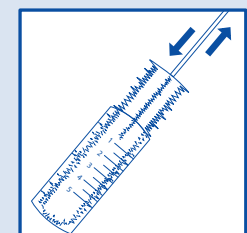

用毛刷清洗玻璃管

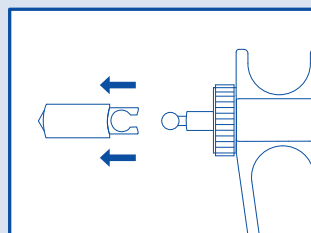

分离活塞，清洗并干燥

## 重新组装

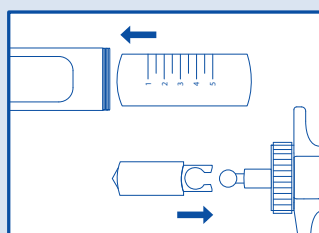

小心安装注射器玻璃管，固定活塞

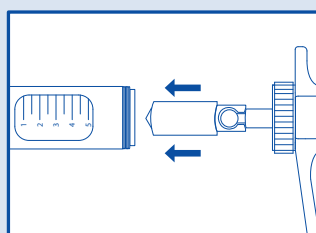

将活塞轻轻插入玻璃管中，然后拧紧螺钉

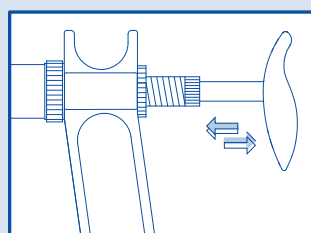

使用一两次，检查功能是否正常



I.SYR.CN A1218