



micropipette for 1:10 dilutions

Acura® 810

Air displacement pipette with two pre-calibrated steps allows subsequent pipetting of 1 and 0.1 mL of the same liquid. Metal nozzle fits long straw tips to aspirate from narrow or deep reservoirs (i.e. Stomacher® bags). Ideal alternative to the graduated pipettes when performing serial 1:10 dilutions in bacteriology.

Product advantages

- Two pre-calibrated fixed volumes - no setting required
- Smooth activation, excellent ergonomics
- Interchangeable PE nozzle protection filter
- **Justip™ system** for height adjustment of tip ejector
- Both volumes calibrated independently
- Easy maintenance, cleaning and disinfection
- Fully autoclavable at 121°C / 250°F

Simple operation

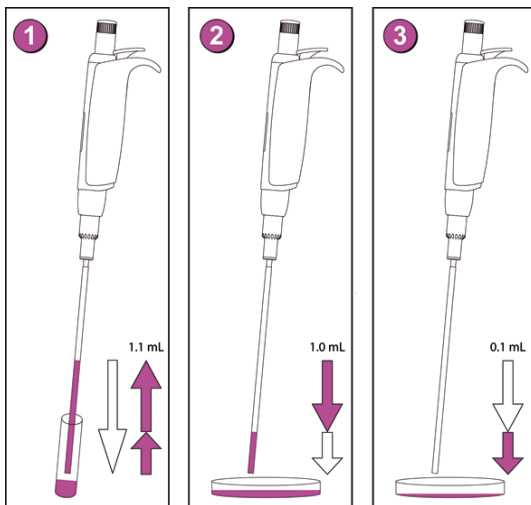

1. Depress plunger button in full, then release slowly to aspirate 1.1 mL
2. Depress plunger button to first stop, thus dispensing 1 mL in Petri dish
3. Depress plunger button to second stop, thus dispensing residual 0.1 mL in next Petri dish

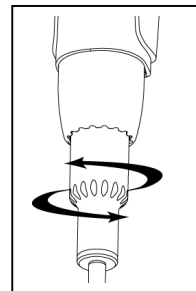

Justip™ ejector

Turn left or right to adjust ejector to tip position on the nozzle

Straw tips

- First class polypropylene material
- 190 mm length >> specially designed for narrow vials and Stomacher® bags
- 4 mm diameter >> no blocking by particles in suspension



Ordering information - Instrument

Volume	Inaccuracy (E%)	Imprecision (CV%)	Cat. No.
1 + 0.1 mL	< +/- 0.5 %	< 0.4 %	810.1100
	< +/- 2.0 %	< 2.5 %	

Performance values obtained with bi-dist. water at constant temperature (± 0.5°C) comprised between 20 and 25°C in accordance with EN ISO 8655.

Accessories

Description	Packaging	Cat. Nr.
PP straw tips, sterile	20 x 25 /pack	313.1100
Nozzle filter	100 /pack	322.810
Workstation 340	1 /pack	320.340

For more information or for an overview of the complete Socorex product range, type www.socorex.com



SOCOREX ISBA S.A. □ CHAMP COLOMB 7 □ P.O. BOX □ 1024 ECUBLENS □ SWITZERLAND
socorex@socorex.com □ www.socorex.com □ TEL. +41 21 651 6000 □ FAX +41 21 651 6001

