

Quick Guide

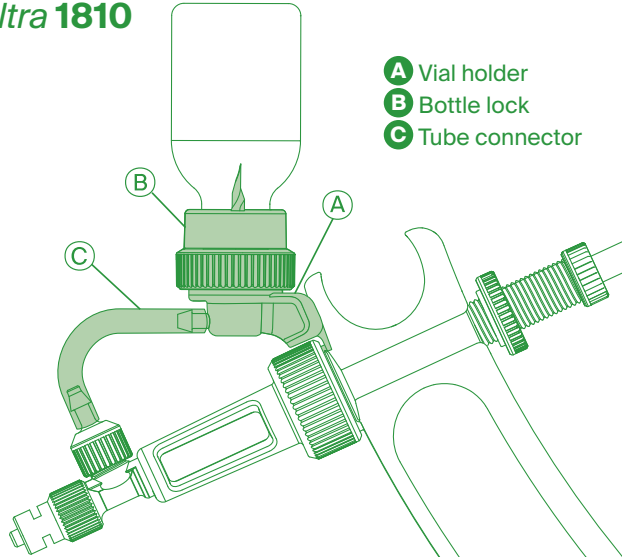

Vial holder for Socorex® syringes ultra 1810



- A** Vial holder
- B** Bottle lock
- C** Tube connector

Related item	Packaging	Cat. No.
Replacement tube connector, 55 mm	1 / pk	1810.716
Needle assembly	1 / pk	1810.386
Bottle lock	1 / pk	1810.347
DuckBill valve	10 / pk	1810.975



Package contents

Vial holder, tube connector and bottle lock.



Safety precautions

- Read carefully and observe manufacturer's instructions before use.
- This accessory is intended for use with Socorex *ultra* 1810 syringe.

Step-by-step instructions

1) Body positioning

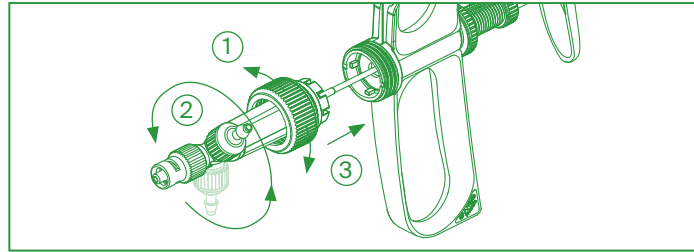

① Unscrew casing nut. Pull. ② Place intake valve in vertical position. Twist glass cylinder to see graduation. ③ Push.

2) Assembling

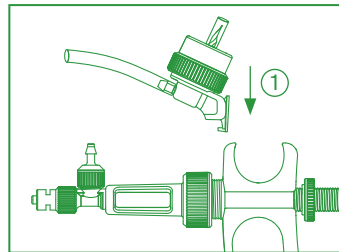

① Insert vial holder body until abutment.

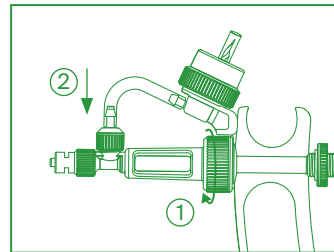

① Tighten casing nut to lock vial holder body. ② Connect tubing to intake valve.

3) Bottle mounting

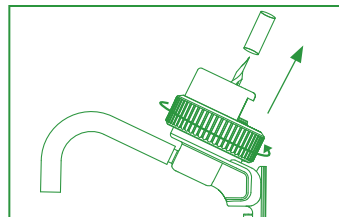

Remove bottle lock and protection over needle assembly.

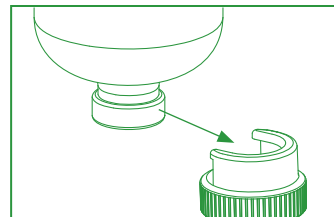

Insert bottle into lock. To be used only with septum bottle Ø 20 mm max.

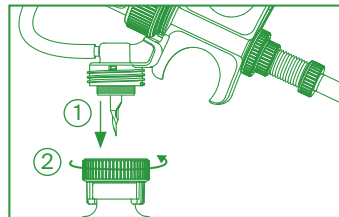

Holding syringe upside down, pierce septum with needle ①. ② Screw to tightly lock bottle.

4) Priming

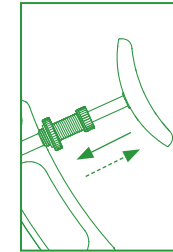

Turn syringe, activate to aspirate and expel liquid.

5) Bottle removing

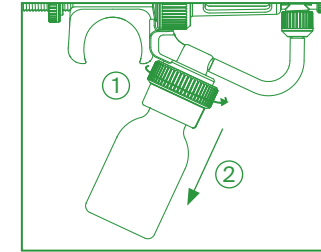

Turn Syringe upside down. ① Unscrew lock to remove bottle ②.

6) Purging and rinsing

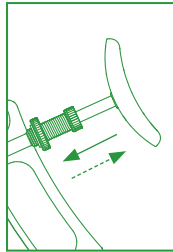

Turn syringe, activate plunger to remove liquid.



Disassembling and cleaning

Disassemble and clean according to syringe instructions.

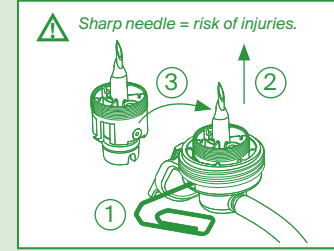

In case of damaged needle assembly

① Push clip and ② pull-out needle assembly. ③ Insert new needle assembly. Do not pierce the same bottle several times.

Scan to access:

Video on vial holder installation



Syringe operating instructions

