

# SOCOREX® SELF-REFILLING SYRINGES 167/187/287

## Quick Guide

### Volume setting

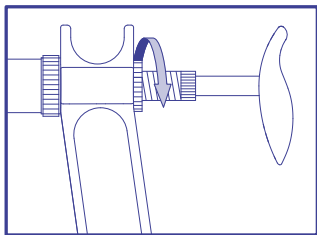

Unscrew locking nut.

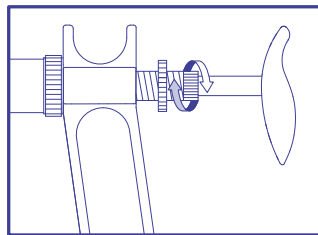

Adjust plunger to desired volume.

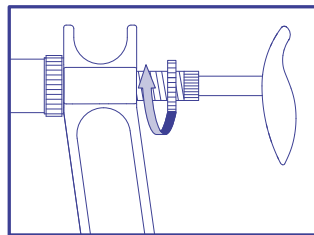

Tighten locking nut.

### Body positioning

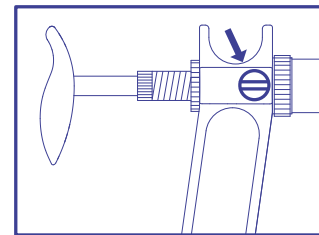

Adjust body / grip position using locking screw on handle side.

### Installing accessories: Tubing

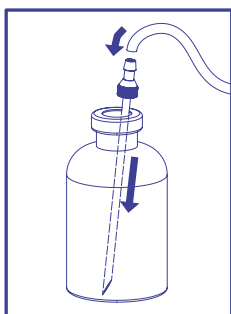

Insert feed needle.  
Connect tubing.

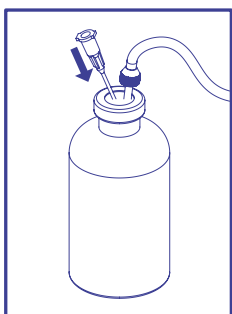

Insert vent cannula.

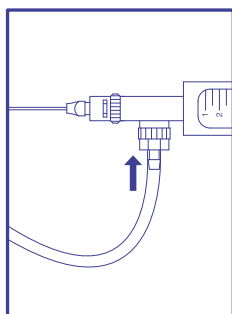

Attach tubing to syringe.

### Vial holder

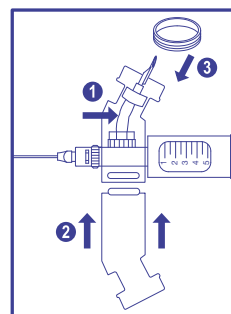

Insert connecting tube and needle, assemble parts.

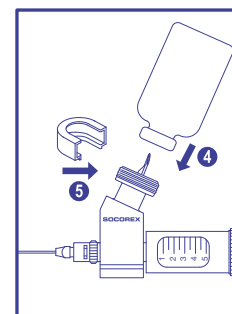

Pierce bottle rubber stopper, lock bottle.

### Priming

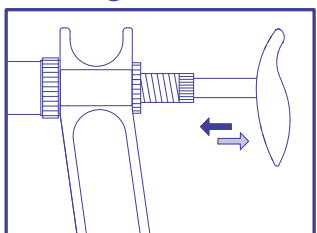

Activate handle until liquid reaches needle.

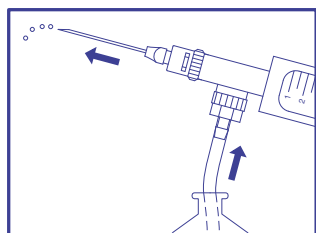

Activate in vertical position to expel liquid and eliminate any air bubble.

### In case of clogged valves

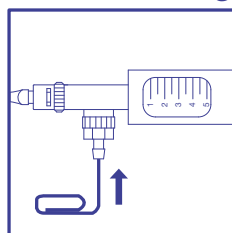

Introduce small pin and push to loosen ball in valve.

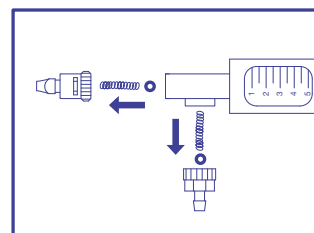

If insufficient, disassemble valves and clean.

### Daily maintenance: Purge, disassembling and cleaning

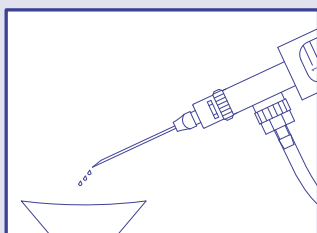

Rinse with warm water and purge completely.

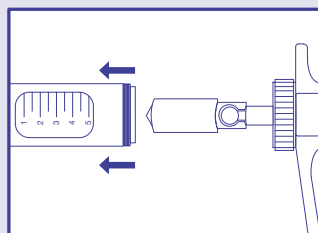

Unscrew body and remove.

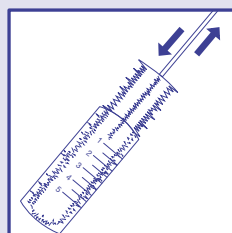

Clean residues in glass barrel with a brush.

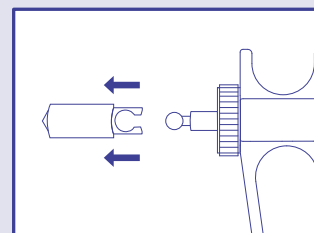

Detach plunger, clean and let dry.

### Reassembling

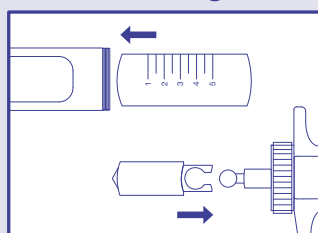

Carefully reassemble glass barrel into body. Attach plunger to handle rod.

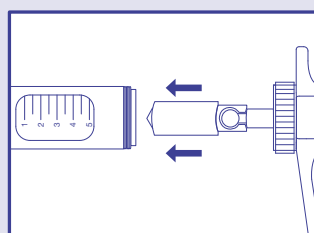

Gently insert plunger into glass barrel then screw body.

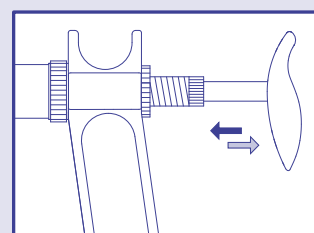

Activate one or two times to check proper functioning.



I.SYR.E - C0319